

Dinsdag 31 Mei 2022 | 13:00 uur  
Meld je hier aan voor het seminar!  
“A roadmap for Creo Parametric Efficiency”



**TFH** technical services

**S** SOFTWARE FACTORY **TECH** SOFT **valk**  **welding** **ASML** **elfsquad**<sup>®</sup>

**TFH** technical services

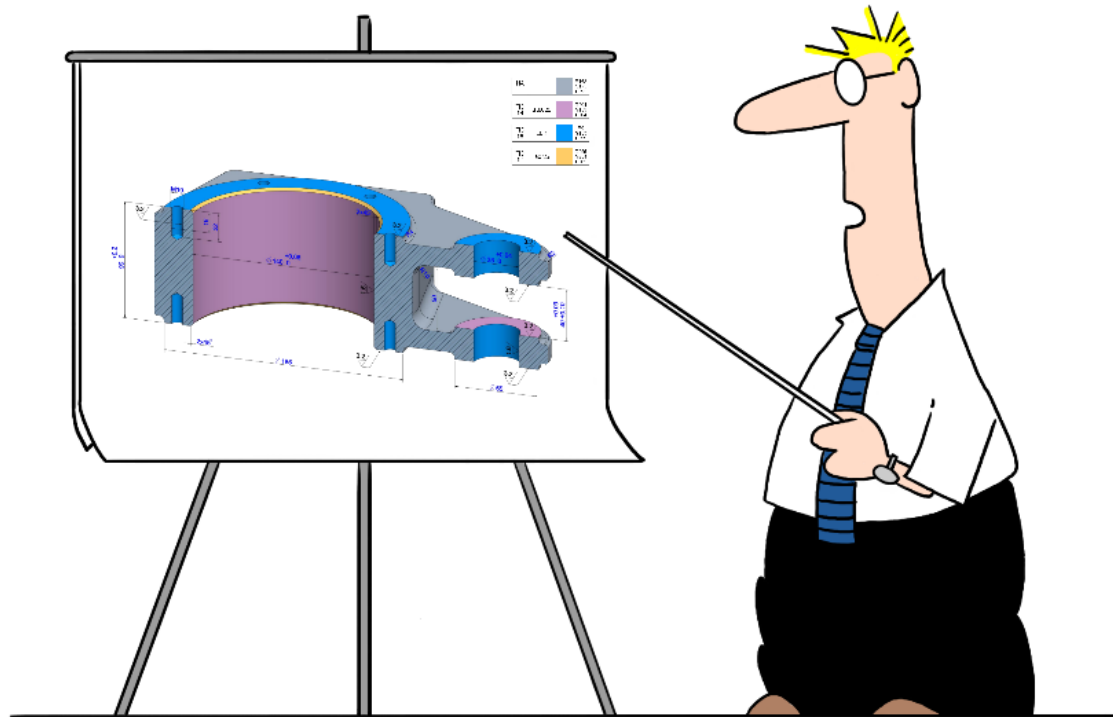

MBD gives us the opportunity to put more info in CAD Model

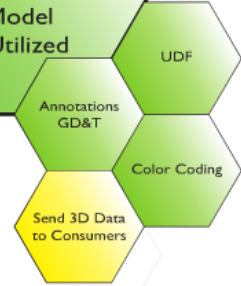
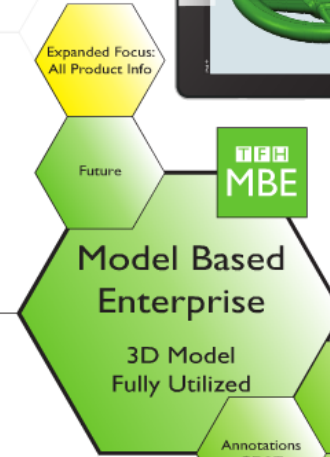
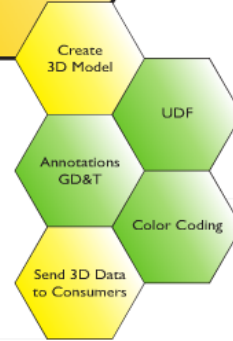
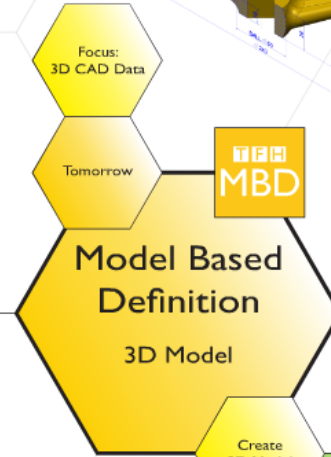
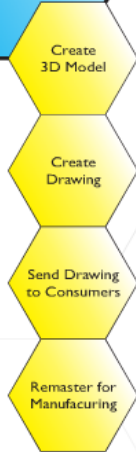
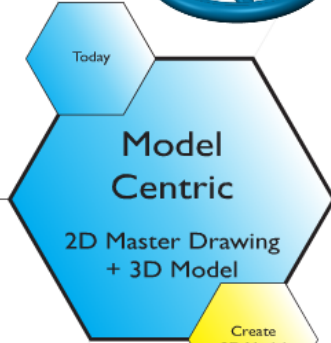
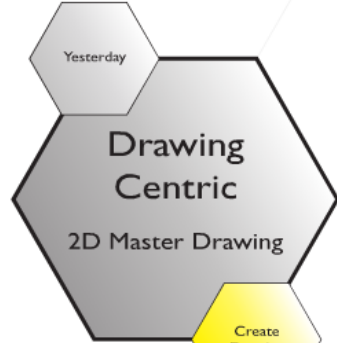
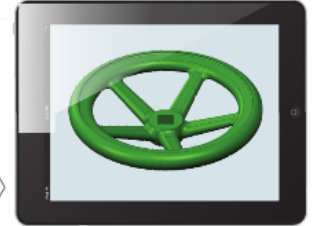
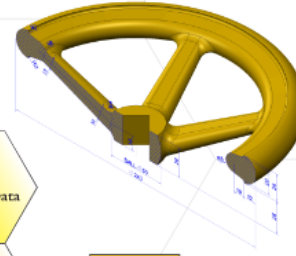
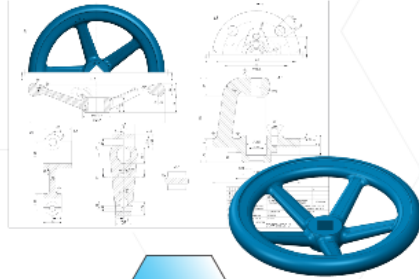
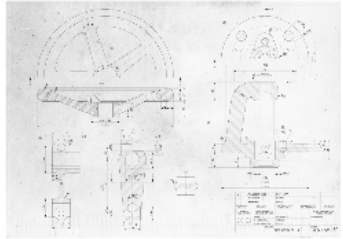

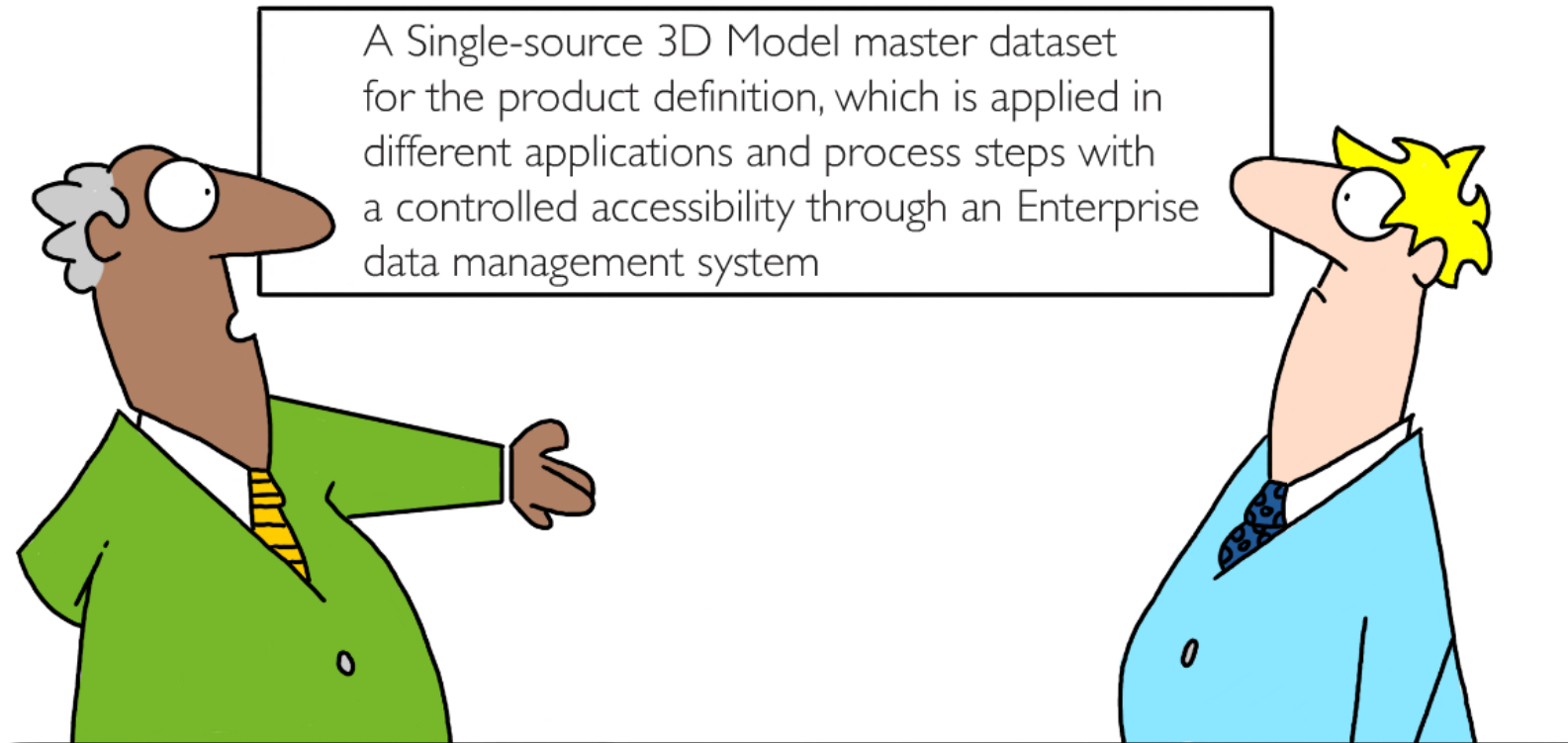

A Single-source 3D Model master dataset for the product definition, which is applied in different applications and process steps with a controlled accessibility through an Enterprise data management system

What does Model Based Definition mean



MBD is a business process to enable more efficient product development

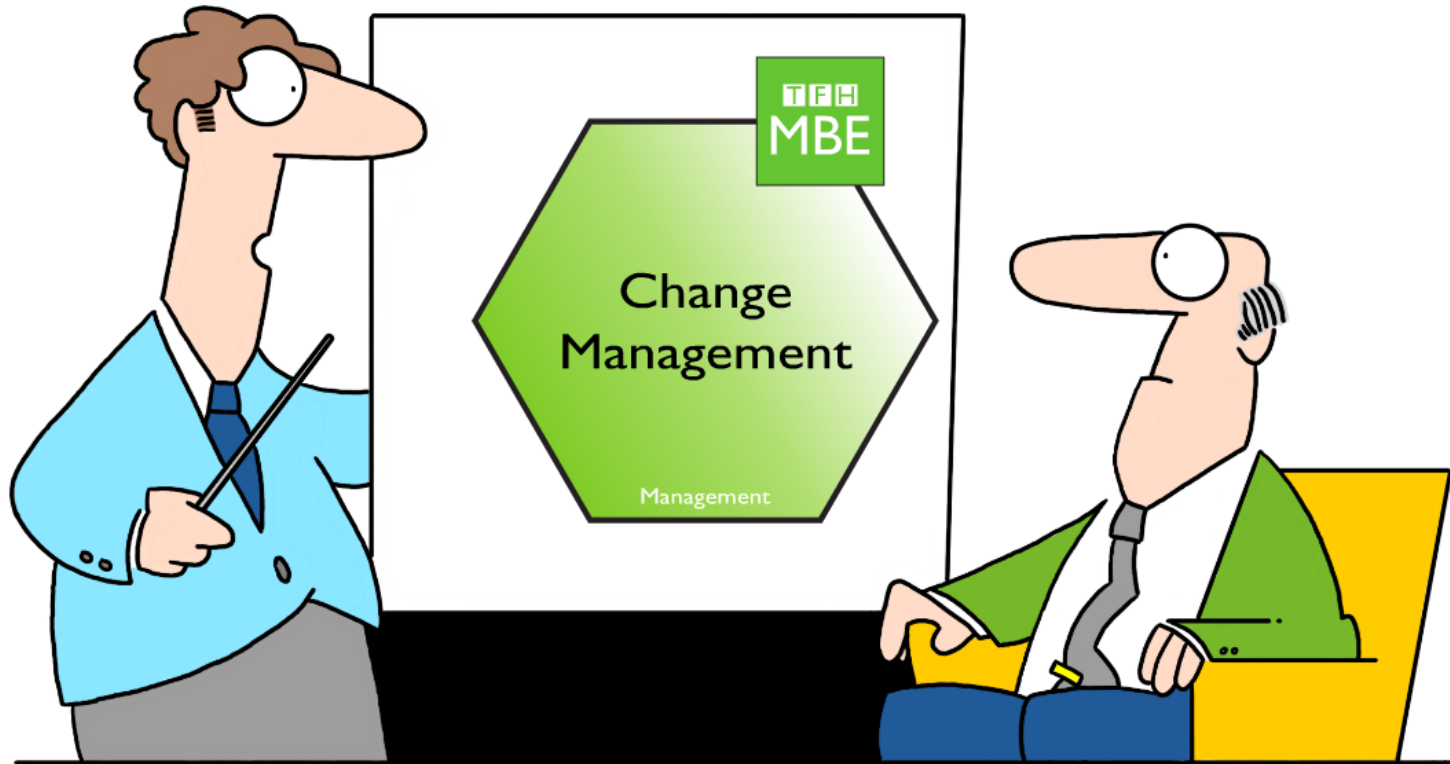

You can't isolate MBD from whatever you are doing in your organisation

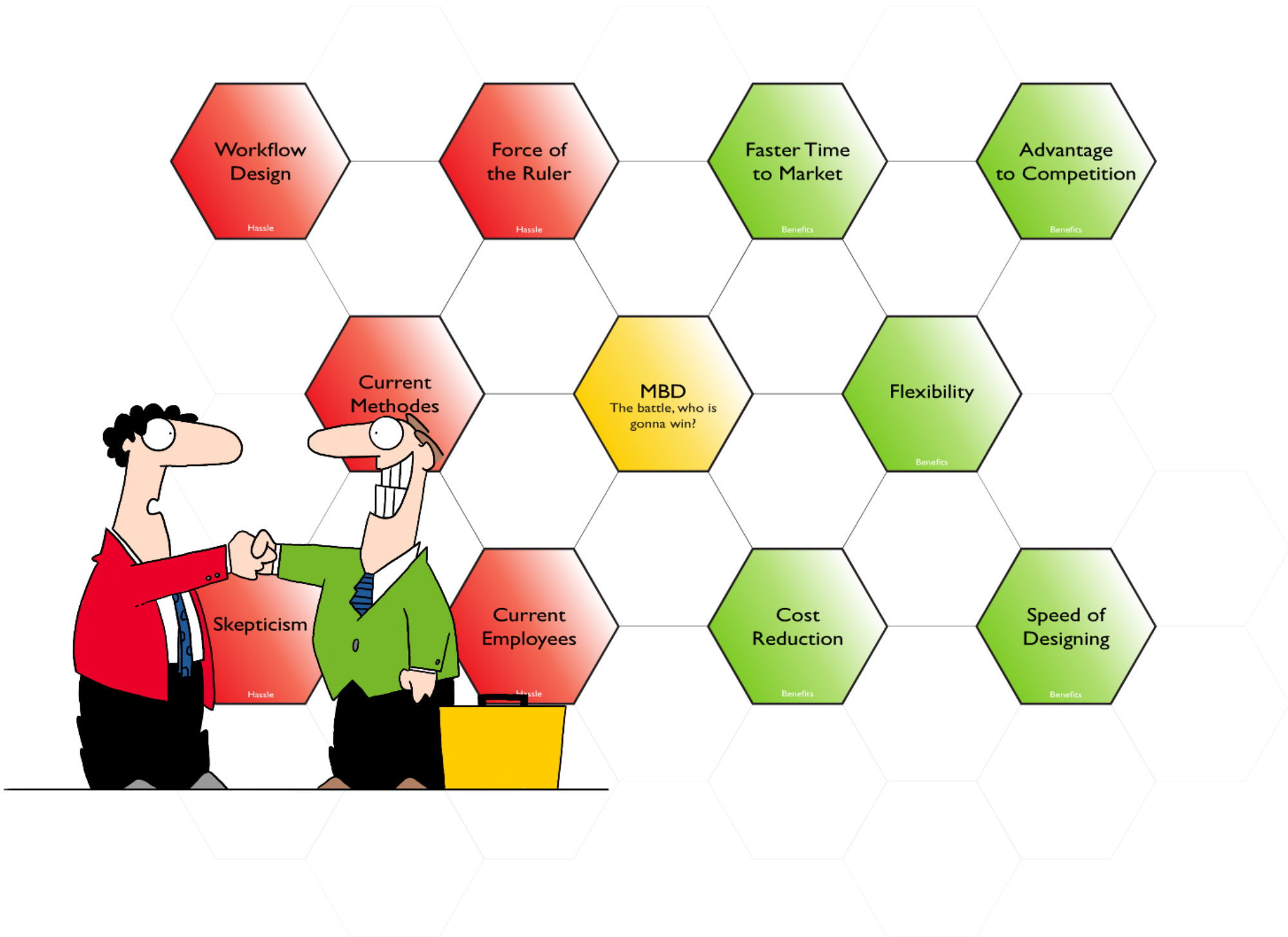



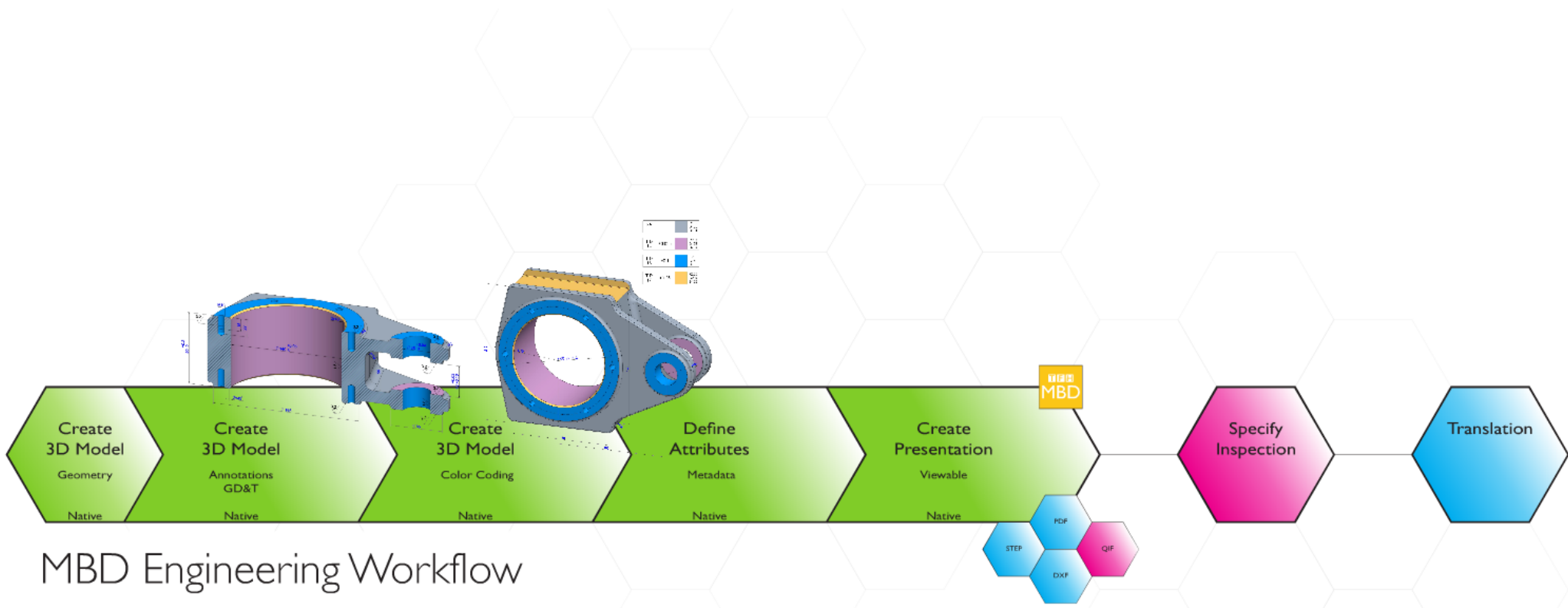

# MBD Engineering Workflow

## Color Coding in CAD Model

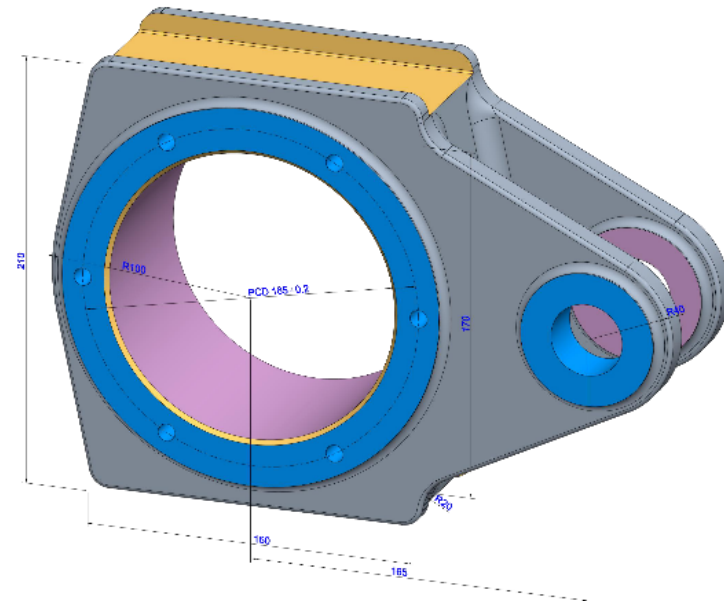
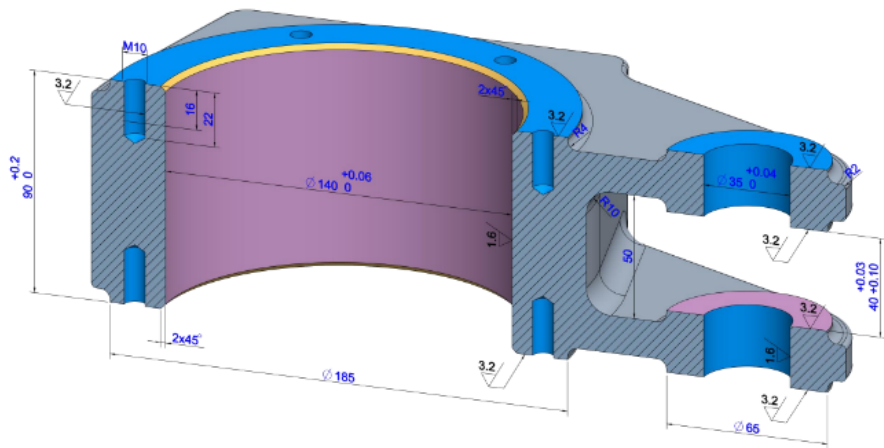

NA		R182 G175 B191
TID 14	$\pm 0.025$	R204 G153 B204
TID 16	$\pm 0.1$	R0 G153 B200
TID 17	$\pm 0.25$	R255 G204 B102

## Color Coding Definition

- All CAD data (*dimensions*) nominal
- All colors represent tolerance, surface treatment or additional info
- Base coordinate system has to be defined (Reference for CAD/CAM and CMM)
- GD&T
- Only additional dimensions are allowed, in case color coding could not be defined (*curves, intersections, edges*)

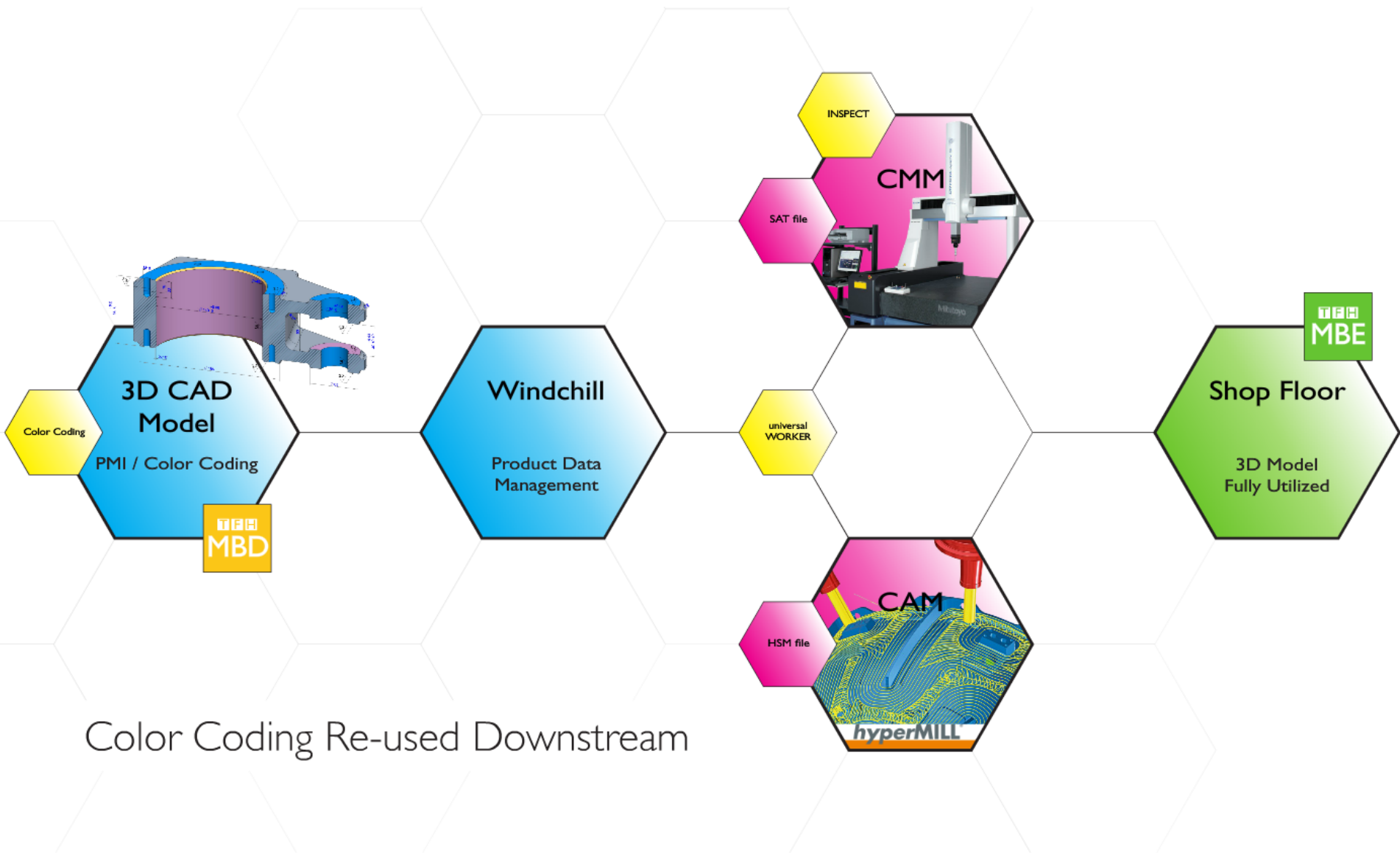

Color Coding Re-used Downstream

100% Product definition in the CAD model

Quality enhancement CAD model



MBD Benefits

30-50% Time reduction on engineering

Consistency by "I way of working"



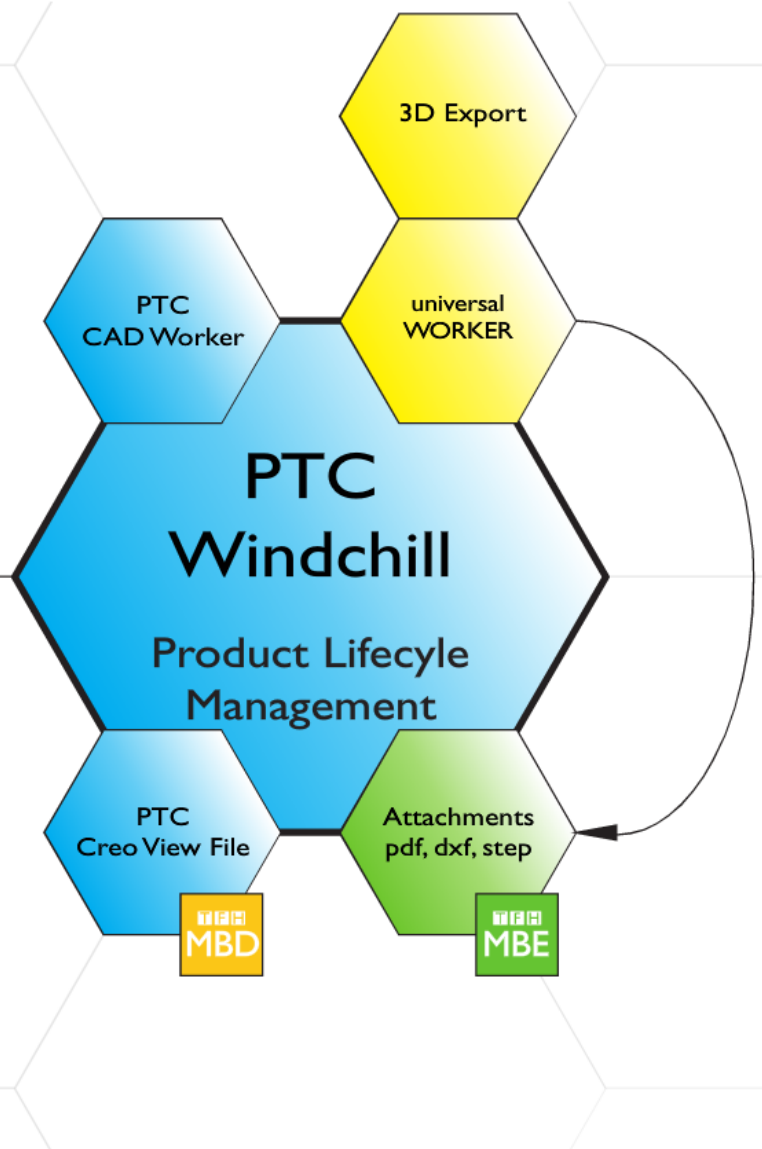
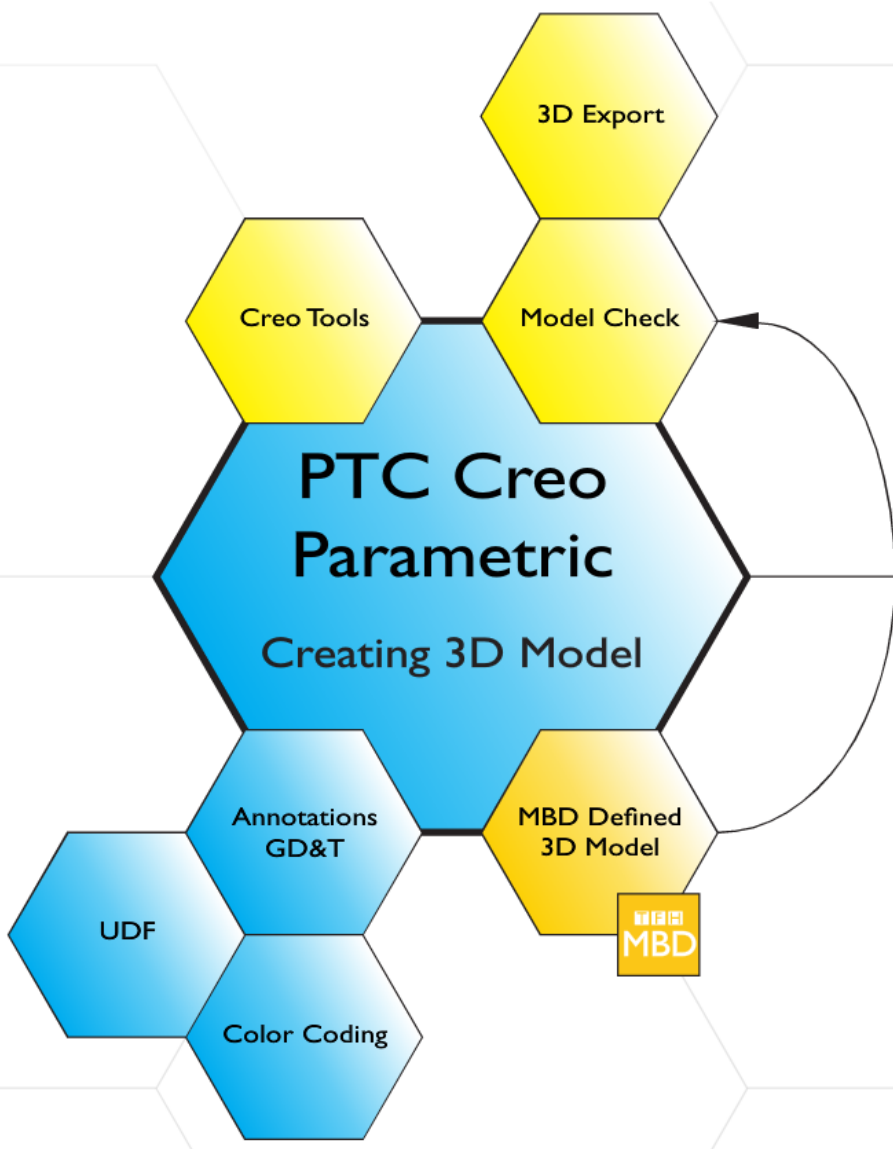

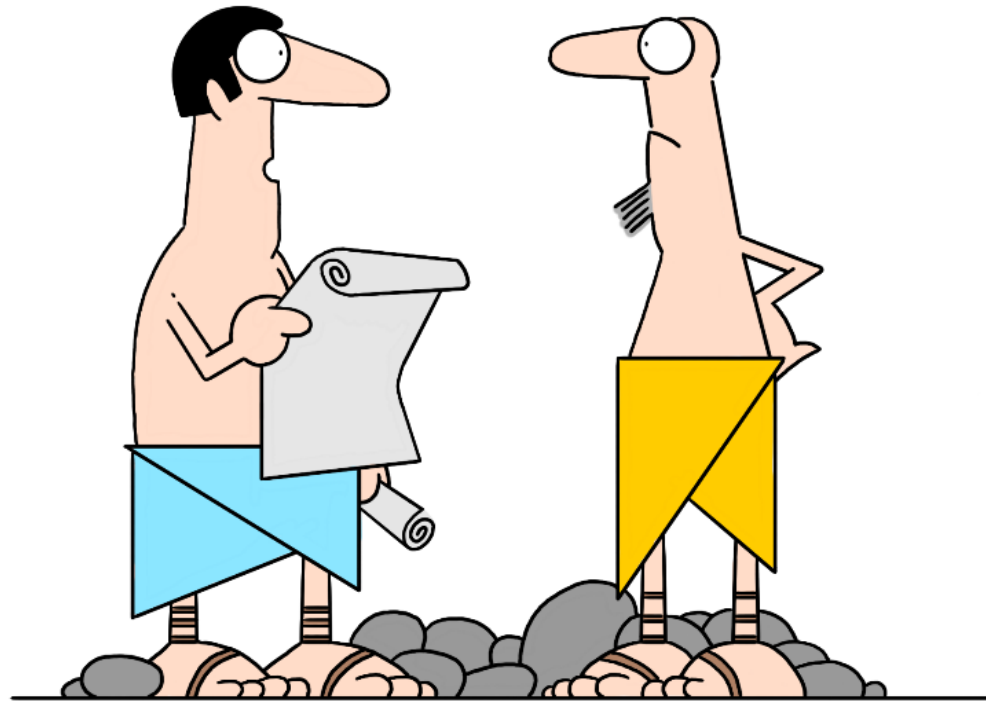

“Even if we are fully convinced of the need to change,  
every fiber in or body will resist changing”

Aristoteles

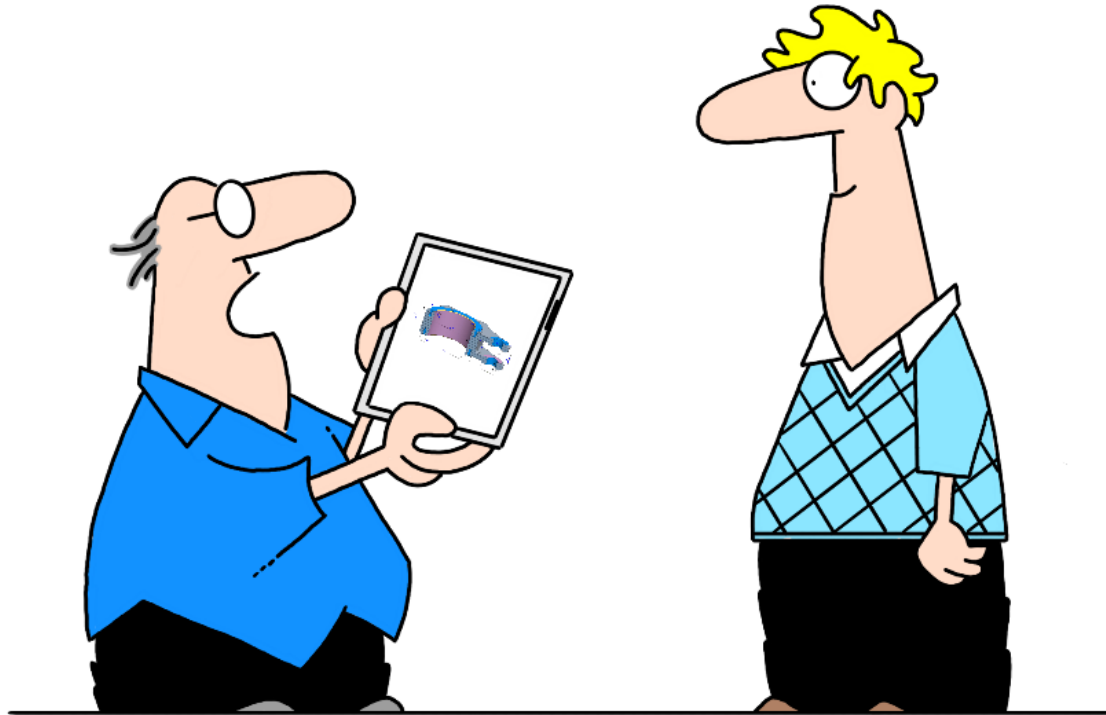

How about a demo as the first step to see the definition?



Innovations  
keep up with us

**TFH** technical services